

Job Name: _____

Type: _____

Part #: _____

Notes: _____

LL3-0115D

LL3-0615D

Wall Sconce

Construction:

- Die Formed Cold Rolled Steel
- Standard Finish: Silver- Gray Plastic Accents
- Shade: White Acrylic
- Dimensions:
LL3-0115D: 12.2"W x 5.5"H x 4.0"E
LL3-0615D: 18.2"W x 5.5"H x 4.0"E

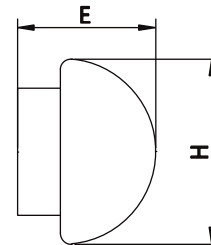

Performance:

- **LL3-0115D:** UNV/14w/1120lms Delivered@3k/80CRI/Non-Dimming Standard
- **LL3-0615D:** UNV/15w/1200lms Delivered@3k/80CRI/Non-Dimming Standard
- Triac and 010v Dimming Optional

Certification/Warranty:

- UL/cUL or ETL/cETL Listed
- Energy Star Rated
- Damp Location Rated
- 5 Year Limited Warranty on Driver and LED
- 1 Year Warranty Against Manufacturing Defects on Housing and Shade



ORDERING INFORMATION

Model	Color Temp	Finish	Options
LL3-0115D LL3-0615D	30K 40K	SVG <small>* ORB by Special Order - may require MOQ and longer lead times</small>	Dim-Triac Dim-010V

May be available in other wattages, voltages, color temperatures, finishes, and lamping sources with orders of 50 units or more. Contact your rep or the factory for more information.

Note: Specifications are subject to change without notice.