

# LLCYL-8-G2

## 8" LED Cylinder - Available in Ceiling, Wall, and Pendant Mount

**Construction:** Powder Coated Aluminum  
**Reflector:** Choice of 5 Reflectors

**Finishes:** Semi-Matte White (SMWH), Black (BLK), Bronze (BRZ) and Silver (SLV)

**Light Source:**

- 10W:** 120~277V/10W/1,000lm Beam Angle 67.7°
- 14W:** 120~277V/14W/1,400lm Beam Angle 75°
- 22W:** 120~277V/22W/2,200lm Beam Angle 75.5°
- 30W:** 120~277V/30W/3,000lm Beam Angle 77°
- 44W:** 120~277V/44W/4,400lm Beam Angle 77°
- Available in 80 or 90 CRI
- Select from 27K, 30K, 35K or 40K
- Triac/ELV – 5-100%; 120v
- 0-10V – 5-100%; 120v or 277v
- EM: Battery Backup: 9W/800lms (approx.), 90 minutes after full charge.

**Notes/Certifications/Warranty:**

- Operating Temperature -22° F to 104° F (-30°C to 40°C).
- Buy American Act Compliant
- cCSA-us Listed-See Trims for Location Ratings (Damp or Wet)
- 5 Year Limited Warranty on LED and Housing

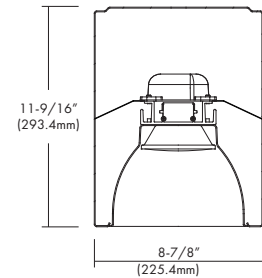

Ceiling Mount

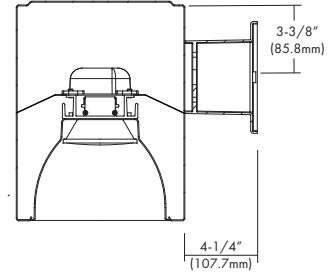

Wall Mount

**Ceiling and Wall Mount Ordering Information:**

PART#	WATTS	COLOR TEMP	CRI	DRIVER	FINISH	TRIM	OPTIONS
LLCYL-8-G2-C <i>(Ceiling Mount)</i>	10W 14W 22W	27K 30K 35K	8 9	UTD: 120~277VAC, Triac/ELV Dimming (14W, 22W & 30W Only) *TRIAC/ELV Dimming at 120V Only	SMWH BLK ORB SLV	Order on Page 2.	EM: Emergency Driver BIEM: Bodine Integral EM
LLCYL-8-G2-W <i>(Wall Mount)</i>	30W 44W	35K 40K		UZTD: 120~277VAC, 0~10V Dimming (10W, 14W, 22W, 30W & 44W)			

\*TRIAC/ELV Dimming at 120V Only

**Pendant Mount Ordering Information:**

PART#	PENDANT STYLE	STEM For Swivel	CABLE & CORD LENGTH	WATTS	COLOR TEMP	CRI	DRIVER	FINISH	TRIM	OPTIONS
LLCYL-8-G2-P	R: Rigid Stem <i>(Select Stem Length)</i> S: Swivel Mount <i>(Select Stem Length)</i> C: Cord & Cable <i>(Select Cable and Cord Length)</i>	12" 18" 24" 36" 48"	C32: 32" C58: 58" C108: 108" C128: 128"	10W 14W 22W 30W 44W	27K 30K 35K 40K	8 9	UTD: 120~277VAC, Triac/ELV Dimming (14W, 22W & 30W Only) *TRIAC/ELV Dimming at 120V Only  UZTD: 120~277VAC, 0~10V Dimming (10W, 14W, 22W, 30W, & 44W)	SMWH BLK ORB SLV	Order on Page 2.	EM: Emergency Driver BIEM: Bodine Integral EM

## TRIMS

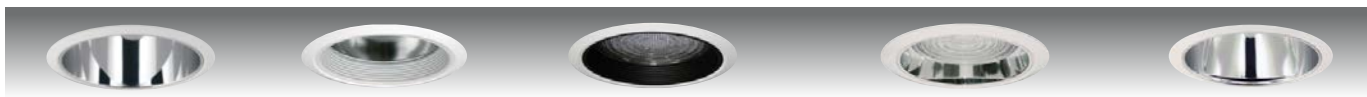

**8TRMSOR**  
Specular Open Reflector  
Damp Location Rated

**8TRMBFR**  
Baffle w / Reflector  
Damp Location Rating

**8TRMBFRL-W**  
Baffle w /Regressed Fresnel  
Lens. Wet Location Rated.

**8TRMSRL-W**  
Reflector w / Clear Collar and  
Regressed Fresnel Lens.  
Wet Location Rated.

**8TRMWW**  
Wall Wash w /  
Reflector Plate  
Damp Location Rated

\* Wide beam reflector is standard. Also available in narrow beam in reflector (consult with factory).

Trim	Reflector Finish <i>(Select for all except 8TRMBFRL-W)</i>	Baffle Finish for 8TRMBFR & 8TRMBFRL-W
<b>8TRMSOR</b> <b>8TRMBFR</b> <b>8TRMBFRL-W</b> <b>8TRMSRL-W</b> <b>8TRMWW</b>  <i>^Select Baffle Finish for 8TRMSOR and 8TRMBFRL-W</i>	<b>HC:</b> Haze Clear <b>WH:</b> White Painted	<b>WH</b> White <b>BLK</b> Black

## PHOTOMETRIC REPORT

\* Contact Factory for IES File

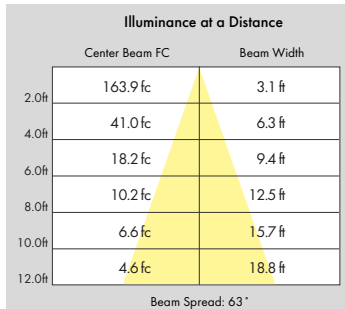
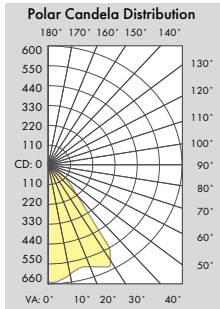

LLCYL-8-G2-14W

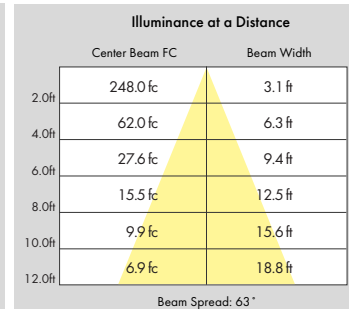
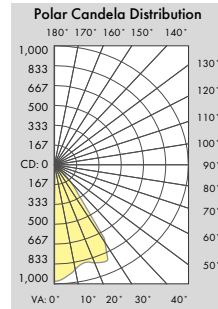

LLCYL-8-G2-23W

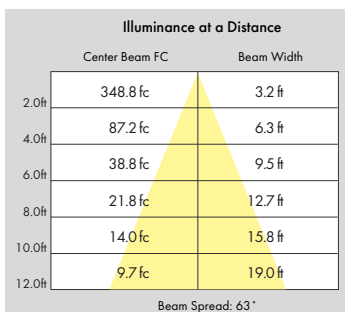
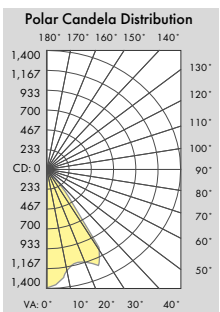

LLCYL-8-G2-30W

### ○ Triac/ELV/0-10V Approved Dimmers

**\* Lutron:**

Triac: Skylark S-600  
 ELV: NovaT NTELV-300 & 600  
 Diva DVELV-300P & 303P  
 Maestro MAELV-600  
 Skylark SEL-VB-300P

0-10V: Diva DDTV

Divia DVSTV-IV

CFL/LED: Diva DVCL-253P

Ariadni AYCL-253P

**\* Leviton:**

Triac: Trimatron #705W  
 ELV: IPE04-1L (ELV)  
 Acenti: ATE06-1LW

\* Consult tech. service or factory for additional dimmers