

**LLFL2103D**

**LLFL2105D**

**LLFL2106D**

**Satin Nickel Wall Sconce with White Acrylic Shade.**



**Dimensions:**

- **LLFL2103D:** 24.5"L x 5.7"H x 4.5"E
- **LLFL2105D:** 36.5"L x 5.7"H x 4.5"E
- **LLFL2106D:** 48.5"L x 5.7"H x 4.5"E
- **LLFL2103D-JA8-SN:** 24.5"L x 5.7"H x 4.5"E

**Light Source:**

- **LLFL2103D:** UNV/22w/2200lm Del@30K/80CRI/Non-Dimming 010v Dimming Optional
- **LLFL2105D:** UNV/36w/3260lm Del@30K/80CRI/Non-Dimming 010v Dimming Optional
- **LLFL2106D:** UNV/46w/4600lm Del@30k/80CRI/Non-Dimming 010v Dimming Optional

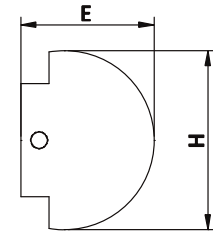

- **LLFL2103D-JA8-30K-SN:** UNV/24w/1980lm Del@30k/90CRI/010v Dimming Standard, CEC Listed, Meets T24 JA8. Not Energy Star.

**Notes/Certification/Warranty:**

- Die Formed Cold Rolled Steel
- UNV=Universal Voltage 120-277V
- MCT Available: Selectable Color Temp 30K, 35K and 40K
- UL/cUL or ETL/cETL Listed
- Energy Star Rated (*except JA8 Version*)
- Damp Location Rated
- 5 Year Limited Warranty on Driver and LED
- 1 Year Warranty Against Manufacturing Defects on Housing and Shade



**ORDERING INFORMATION**

Model	Color Temp	Finish	Options
LLFL2103D	MCT 30K 40K	SN CC*	010V: 0-10V Dimming EM- Emergency Battery Back Up
LLFL2105D LLFL2106D	30K 40K MCT*		
LLFL2103D-JA8-30K-SN			

\*Special Order Items may require longer lead times and MOQ. May be available in other wattages, voltages, color temperatures, finishes, and lamping sources with orders of 50 units or more. Contact your rep or the factory for more information.