



Job Name: \_\_\_\_\_

Type: \_\_\_\_\_

Part #: \_\_\_\_\_

Notes: \_\_\_\_\_

## LLFL371 LLFL372

Enclosed and Gasketed Wall or Ceiling Mounted Bulkhead.  
Available in 2 Finishes with a White Polycarbonate Diffuser.

### Construction:

- Powder Coated Cast Aluminum

**Finishes:** Black (BLK) and White (WH)

### Light Sources:

- **LE12**-120V/14W/80CRI/1430LM@30K, 1500LM@40K/TRIAC
- **LE18**-120V/22W/80CRI/1950LM@30K, 2130LM@40K/TRIAC
- **LE26**-120V/32W/80CRI/2700LM@30K, 2750LM@40K/TRIAC
- **UNV18**- UNV/22W/74CRI(TYP)/1740LM@30K, 1824LM@40K/Non-Dimming

### Notes/Certifications/Warranty:

- 120V
- Optional Motion Sensor
- Optional Emergency Battery Backup for LE Versions
- LED Operating Temperature -40°C to +40°C
- ETL Listed for Wet Locations
- IP65
- RoHS Compliant
- Energy Star Rated when fitted with the LE12 and LE18 light Sources only
- 5 Year Warranty on LE Versions
- 3 Year Warranty on L18U Version



LLFL371



LLFL372

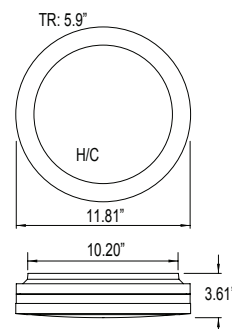

Optional Battery Backup



- 135 Min. of Emergency Backup
- Test Switch/LED Charge Indicator 4W
- LED Backup Array
- NiCd, 3.6 VDC Battery
- 24hr Recharge Time
- Ambient Temp: 0°C to +40°C
- 5yr Warranty

PART #	LIGHT SOURCE	COLOR TEMP	FINISH	DIFFUSER	OPTIONS
LLFL371 LLFL372	LE12 LE18 LE26	30K 40K	BLK- Black WH-White	W-White	MS- Motion Sensor EB- Emergency Battery Backup  Motion Sensor and Emergency Backup for LE12 and LE18 Versions Only

Recommended Dimmers for LE Series: LUTRON S-600H-WH, LUTRON LG-603PH-AL, LEVITON 6631-LW, LUTRON DIVA DVCL-153P, LUTRON DV6200P-WH, LUTRON SKYLARK S-600P

PART #	COLOR TEMP	FINISH	DIFFUSER	OPTIONS
LLFL371-UNV18 LLFL372-UNV18	30K 40K	BLK- Black WH-White	W-White	MS- Motion Sensor