

Job Name: \_\_\_\_\_

Type: \_\_\_\_\_

Part #: \_\_\_\_\_

Notes: \_\_\_\_\_

## LLW180D Wall Sconce

### Construction:

- Die Formed Cold Rolled Steel.
- Standard Finish: Satin Nickel (SN)
- Shade: Acrylic
- Dimensions: 10.5"W x 5.5"H x 3.8"D

### Performance:

- 120v/14w/706lms Delivered@3k/80CRI

### Notes:

- Non-Dimming Standard.
- Triac and 010v Dimming Optional.

### Certification/Warranty:

- ETL/cETL Listed for Damp Locations
- 5 Years Limited Warranty on Driver and LED.
- Energy Star Rated
- 1 Year Warranty Against Manufacturing Defects on Housing.

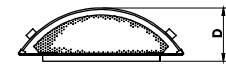
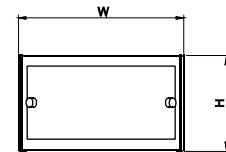

### ORDERING INFORMATION

Model	Color Temp	Finish	Options
LLW180D	30K 40K <small>Other color temps by Special Order. MOQ and longer lead times may apply.</small>	SN* <small>* ORB by Special Order - may require MOQ and longer lead times</small>	Dim-Triac Dim-010V

May be available in other wattages, voltages, color temperatures, finishes, and lamping sources with orders of 50 units or more. Contact your rep or the factory for more information.

Note: Specifications are subject to change without notice.